



SILVERBROW

KITCHENS & INTERIORS

INDIVIDUALLY FOR YOU



HANDCRAFTED KITCHENS

MADE IN BRITAIN
SINCE 1984

Our attention to detail and material sourcing is what defines us, coupled with a personalised approach to design and installation. Rest assured that our team of experts are on hand to guide you through the process from beginning to end.

All of our kitchens are made from scratch in the UK, using the latest technology whilst incorporating traditional handcrafted techniques. This guarantees expert carpentry, which is perfect for those finishing touches and the secret to what makes each kitchen unique.

CLASSIC

Driven by traditional craftsmanship, our Classic collection invites you to create your very own timeless masterpiece. From solid wood grains to smooth painted doors, relive a bit of history and relish in Georgian beauty.

04. DORCHESTER

08. GAWSWORTH

12. COBHAM

16. WICKHAM

20. BOSTON

24. NEWARK

CONTEMPORARY

The clean lines of the matt and gloss finishes for our Contemporary range offer minimalist chic with integrated functionality. Whether you prefer bold statements or subtle highlights, transform your space into a modernist sanctuary.

28. LINEA

32. STRATFORD

36. GENOA

40. ROMA

44. DOOR FINISHES

DORCHESTER

Our Dorchester range is where innovation meets traditional craftsmanship, merging classical country with elegant modernism. Attention to detail defines a Dorchester kitchen, and when it comes to finishing touches, such as smooth painted Shaker doors or curved pilasters, we know what matters most.

Less is beautifully more with this classic design. Rich tones will lift this kitchen out of the walls, guaranteed to have a lasting impression on all your guests.

Authentic touches, such as traditional chic corning and curved in-frame wooden cupboards, sit beautifully within understated cabinetry. Available in a variety of hand-painted woods, find the perfect shade to suit your personality and set the mood.

Shown here in Cottage Green & Natural European Oak.
The Dorchester range is available in both In-frame and Lay-on styles. See *page 50*.

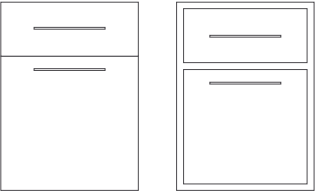

Lay-on design In-frame design

When choosing from our Dorchester range:
All textured finishes are made from painted real Oak with a veneered MDF centre panel (unpainted doors are lacquered only).
Our smooth painted finishes are made from MDF.





Evening Claret
(Smooth & Textured)



Slate
(Smooth & Textured)



See our full range of finishes on pages 104-109.
We're sure to have the perfect colour for you, but if you can't see the one that makes you swoon, then we can have your preferred finish made. *This service is at an additional cost.*

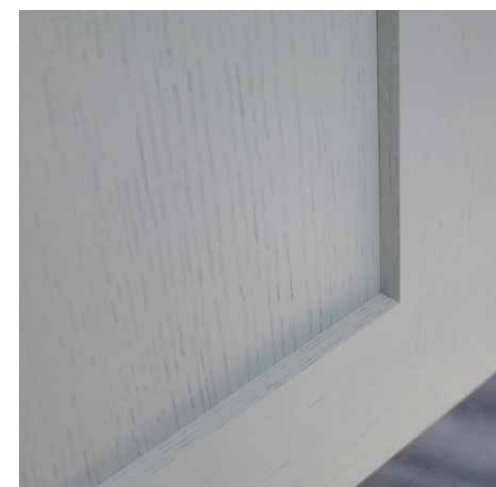

Our Dorchester door frame detail is available in both a textured and smooth finish. Also available in natural wood finish. See page 51 for more information.

GAWSWORTH

For those that prefer a contemporary twist on the classic Shaker style, the Gawsorth collection sticks to the principles of traditional design but with playful hints of modernism.

Bold lines and thick cuts reinforce the strength and stability of the furniture, so you can rest assured that the quality and expertise worked into this model will last not years, but generations.

Passion is at the core of our design process. Stunning features such as butt hinges and bespoke glass door cabinets are just some of the delightful aspects we’ve incorporated into this range. To fulfil that country essence, accessorise with a Belfast sink or stone floor.

Shown here in Blue Mist.
The Gawsorth range is available in both In-frame and Lay-on styles. *See page 50.*

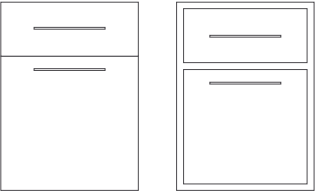

Lay-on design In-frame design

When choosing from our Gawsorth range:
All textured finishes are made from painted real Oak with a veneered MDF centre panel (unpainted doors are lacquered only).
Our smooth painted finishes are made from MDF.





Mustard
(Smooth & Textured)



Gunpowder
(Smooth & Textured)

Painted finishes, such as our Mustard shown here, elevate this classic design. Complement rich hues with handles in natural metals such as brushed nickel or copper.



See our full range of finishes on pages 104-109. We're sure to have the perfect colour for you, but if you can't see the one that makes you swoon, then we can have your preferred finish made. *This service is at an additional cost.*

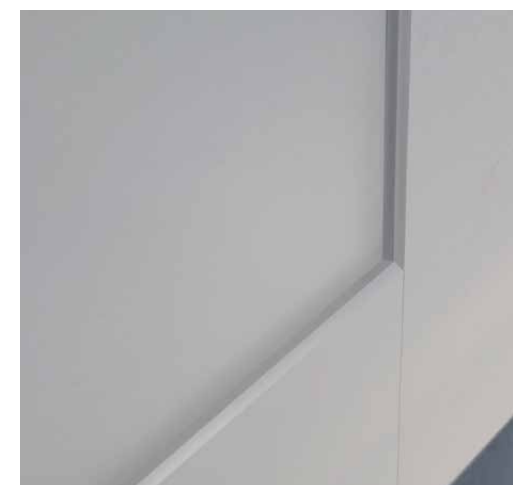

Our Gawsworth bevelled edge door frame detail is available in both a textured and smooth finish. Also available in natural wood finish. See page 51 for more information.

COBHAM

A Cobham kitchen captures true British rural spirit while offering style and practicality. Daylight will dance around warm tones and natural materials, such as our solid woods, to bring that essence of the outdoors under your roof.

Carefully handcrafted Shaker style doors, made from scratch by our carpenters, give the furniture an authentic finish within this timeless design.

Available in a range of timber and painted finishes, the option of Natural Oak or a modern colour twist is at your heart’s desire. If you’re passionate about the touch and texture of your surfaces, you’ll love the wood grain that makes this option a true sensory experience.

Shown here in Twilight & Taupe Grey.
The Cobham range is available in both In-frame and Lay-on styles. *See page 50.*

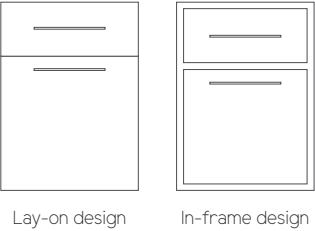

When choosing from our Cobham range:
All textured finishes are made from painted real Oak with a veneered MDF centre panel (unpainted doors are lacquered only).
Our smooth painted finishes are made from MDF.





Shown here in Natural Oak & Olivine.

WICKHAM

The kitchen is the heart of every home, and that’s precisely why we love the welcoming arms of our Wickham collection. Let nature into your space with natural warm timbers, which work beautifully against tones of white and grey.

Natural light will soak up the tall cabinetry to create a spacious room, perfect for relaxing in or hosting family gatherings. Traditional beauty is at this collection’s core. Graceful Georgian features, such as raised and fielded doors, bring a sense of elegance as standard that reflect the high quality craftsmanship that goes into creating each kitchen.

Convenience is key, and an island complete with inset cupboards provides that perfect balance between functionality and luxury.

Shown here in Gunpowder & Light Grey (Smooth)
The Wickham range is available in both In-frame and Lay-on styles. *See page 50.*

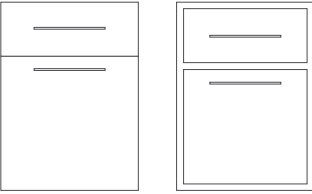

Lay-on design In-frame design

When choosing from our Wickham range:
All textured finishes are made from painted real Oak with a veneered MDF centre panel (unpainted doors are lacquered only).
Our smooth painted finishes are made from MDF.





Blue Mist
(Smooth & Textured)



See our full range of finishes on pages 104-109.
We're sure to have the perfect colour for you, but if you can't see the one that makes you swoon, then we can have your preferred finish made. *This service is at an additional cost.*

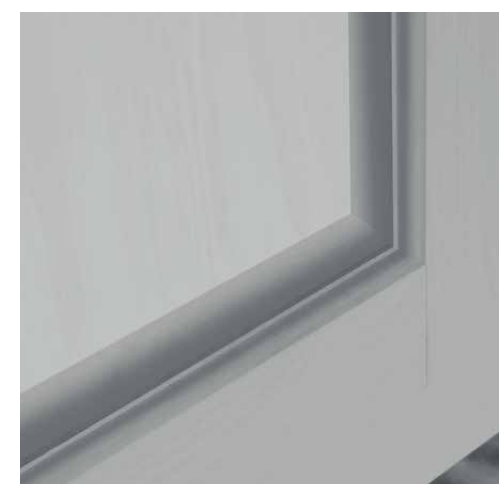

Wickham's intricate door detail is available in both a textured and smooth finish.
Also available in natural wood finish. See page 51 for more information.

BOSTON

The Boston collection is the perfect economical solution that offers value with practical style. Functionality is at the heart of this collection. Vinyl wrapped doors in a range of matt finishes mean this easy to maintain option is perfect for little sticky fingers or mucky paws alike.

Bring a touch of historic luxury into your home with classic features, such as Shaker doors and solid wood work surfaces. Or inject a playful edge using the shapes and lines of your furniture to build something truly original, just like you.

Treat yourself to a piece of practical design with this versatile kitchen, which promises to stand the test of time and become a dependable part of your home.

Shown here in Kombu Green & White (super matt).
The Boston range is available as a Lay-on only. *See page 50.*

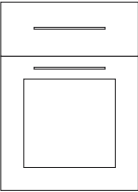

Lay-on design

When choosing from our Boston range:
All finishes are made from routed MDF, wrapped in PVC foil,
with colour matched melamine to the reverse.





Kombu Green
(Super Matt Only)

Our carefully chosen range of matt finishes work beautifully when contrasted with textured worktops.



Boston's smooth door finish adds a delicate touch to the design. Available in smooth matt only.

NEWARK

Thought and precision has gone into refining a design that re-tells the story of the Shaker, but in a modern voice. Our most popular on-trend colours have been carefully hand-picked for this range. The muted palette will look simply stunning against rich paint colours and bold accessories; the perfect opportunity to showcase your personality. Robust and durable, this design will stand the test of time. Delicate proportions and wood grain effect doors offer authentic touches of elegance.

We understand that everyone’s requirements are different. Different homes, lifestyles, needs and design preferences. If you’ve got a specific budget in mind, the Newark offers the beauty and craftsmanship of a Shaker kitchen, but at a cost-effective price. A Newark kitchen is a little something special, that will make a lasting impression.

Shown here in Taupe Grey (Matt Textured).
The Newark range is available in a lay-on style. *See page 50.*

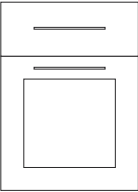

Lay-on design

When choosing from our Newark range:
All finishes are made from MDF, wrapped in a textured PVC foil, with colour matched edging.



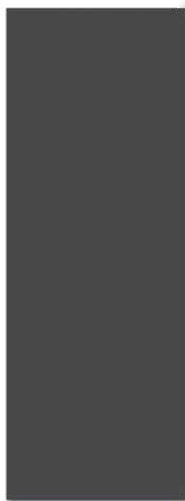

Graphite
(Matt Textured Only)

Give this classic design a modern twist by choosing one of our bolder finishes, such as Graphite. To make a feature of your splashback, try using a contrasting material and colour.



Bring a sensory experience to your kitchen with the textured finish of our Newark doors.

LINEA

Fresh, bright and sleek, this range provides busy lives with a sanctuary to come home to. Its numerous finishes, available in smooth or grained, create a light airy feel, perfect for entertaining or enjoying a quiet bit of solace.

Simplicity in design is carried through to the finer details, such as the urban handle-less trim option available on cupboard doors. Mix and match your design with our range of matt tones and wood grains, finishing it all off with our colour-matched carcasses, that complement this collection perfectly. Longevity is key to this range, constructed from strong durable materials.

Creating focal points, such as contrasting splashbacks, gives balance to the simplicity of this design.

Shown here in Dust Grey & Taupe Grey (Smooth Matt).
The Linea range is available as a Lay-on only. *See page 50.*

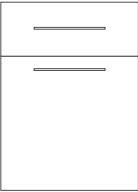

Lay-on design

SEAMLESS DESIGNS

The Linea range is available with a selection of handles to compliment the design. If you prefer a more minimal look however, we also have the 'Urban Handle', that creates a seamless handleless look.

When choosing from our Linea range:
All finishes are Melamine faced Chipboard with varying material effects applied. Available in textured or smooth (to both sides), with colour matched edging.





When using darker tones in smaller spaces, use a lighter neutral tone to help open up the room. Here we've used our Soft Black and Premium White finishes to create a modern understated look.



Soft Black
(Smooth Matt only)

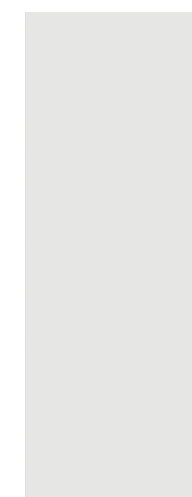

Premium White
(Smooth Matt only)

STRATFORD

The Stratford range is the perfect blank canvas for those who desire to incorporate their own personal marks. Chose from our eclectic range of standard paint finishes that will suit any home - if you can't see the perfect colour, then we can have your very own finish made up (as an optional extra).

Simplicity in furniture design allows further textures to be brought in without overcrowding the feel, such as marble flooring or granite stonework surfaces in contrasting hues. If you're at the beginning of building a home, this will provide the ideal foundation to starting your journey with simplicity and authenticity combined.

Shown here in Slate & Blush (Smooth).
The Stratford range is available in both In-frame and Lay-on styles. *See page 50.*

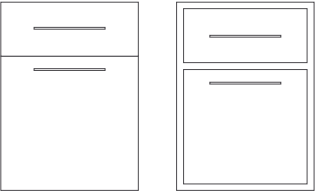

Lay-on design In-frame design

When choosing from our Stratford range:
All textured finishes are made from painted real Oak
(unpainted doors are lacquered only). Our smooth painted
finishes are made from MDF.





Cactus Green
(Smooth & Textured)



Gunpowder
(Smooth & Textured)



See our full range of finishes on pages 104-109.
We're sure to have the perfect colour for you, but if you can't see the one that makes you swoon, then we can have your preferred finish made. *This service is at an additional cost.*

GENOA

Step into urban utopia with this collection that fuses the latest trends with personality and elegance. Exaggerate your space using gloss finishes, or for a subtle effect, try our selection of super matt colours available in couture tones of grey.

Inspired by Nordic design, the face of this collection is simple, sleek and compact. Work surfaces are maximised, space is opened up and integrated storage mean that this kitchen can be clutter free.

With a charisma to match its confidence, invite this high-end design into your home and prepare to be besotted by its charm.

Shown here in Indigo Blue & Dust Grey (Super Matt). Also showing the Handleless 'Urban Handle'. The Genoa range is available as a Lay-on only. *See page 50.*

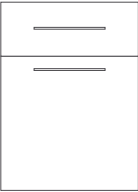

Lay-on design

SEAMLESS DESIGNS

The Linea range is available with a selection of handles to compliment the design. If you prefer a more minimal look however, we also have the 'Urban Handle', that creates a seamless handleless look.

When choosing from our Genoa range: All finishes are made from MDF, laminated with a PET foil, with colour matched melamine to the reverse. With colour matched edging.





Cashmere
(Super Matt Only)

ROMA

Roma is simple but far from plain. Indulge in minimalist chic in a collection that will leave you charmed. Handleless doors add to this collection's magic, keeping simplicity at the forefront of its design.

Clean sweeping lines and soft curves orchestrate a delight for the eye. Explore and extend the space with panels of copper and steel, which work as beautifully in daylight as they do under candlelight suppers.

Integrated features such as a stainless steel twin oven and soft close cabinets moulds this collection's ethos into its design. Step into tomorrow with this no frills approach and leave the clutter of yesterday behind.

Shown here in Cashmere (Gloss) and Anthracite (Super Matt).
The Roma range is available as a Lay-on only. See *page 50*.



Lay-on design

When choosing from our Roma range:
All finishes are made from routed MDF and painted to all
faces. Reverse is always finishes in Matt.





There's nothing like a seamless kitchen design paired with bold finishes to make a room stand out. Our Roma range will work in any open plan space, creating a simple, but bold statement.



Indigo Blue
(Super Matt)

COMPLETE YOUR LOOK

Once you've chosen the perfect range to suit you, it's time to let the fun begin!

From shaping wood in the warehouse, to choosing the perfect grain for a collection, the human touch remains central to the process. Our range of finishes will bring as much tactile delight as they will visually, because every kitchen needs to be inviting, eye catching and most importantly lived in!

Each range has its own carefully picked palette that works in harmony, so explore with matts and gloss, grain and painted, and bring your space to life.

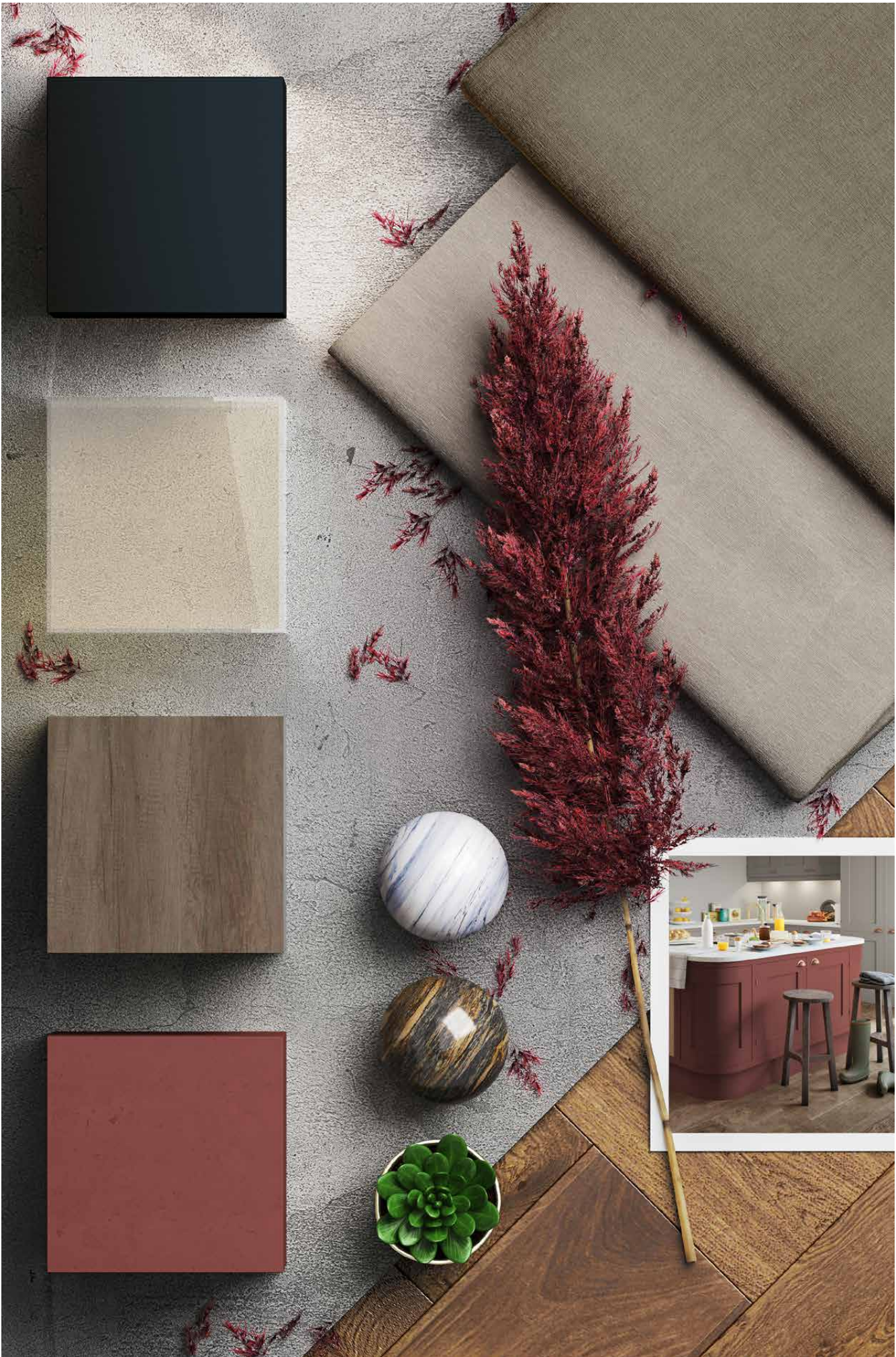

Country - Available in smooth painted MDF and painted real Oak.



Mono - Available in smooth painted MDF and painted real Oak.



Love Colour - Available in smooth painted MDF and painted real Oak.



We have a colour for all house types and personalities, but if you can't find one that you truly love, then we can have your favourite finish made for you. Speak to one of our designers for more information. *This service is at an additional cost.*

Natural - Fully lacquered real wood.

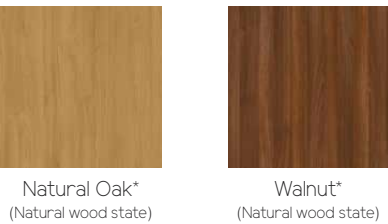

* Natural Oak is available to all Classic door ranges.
* Walnut is available for Cobham, Dorchester, Gawsworth and Wickham ranges only.

COMPLIMENTING CARCASE

Our Dorchester, Gawsworth, Cobham, Wickham and Stratford ranges are complimented with either the Natural European Oak or Walnut wood finishes. Also available in one of our standard carcase finishes.

Note: Textured refers to painted wood doors with the grain still visible. Smooth refers to texture free MDF painted wood doors.

Note: All finishes are representative. Due to print these will not exactly match the finished product. To see these finishes speak to your local showroom for physical samples.

Uni-Colours - Available in smooth laminated chipboard, with colour matched edging.



Natural Effect - Available in smooth or textured laminated chipboard, with colour matched edging.

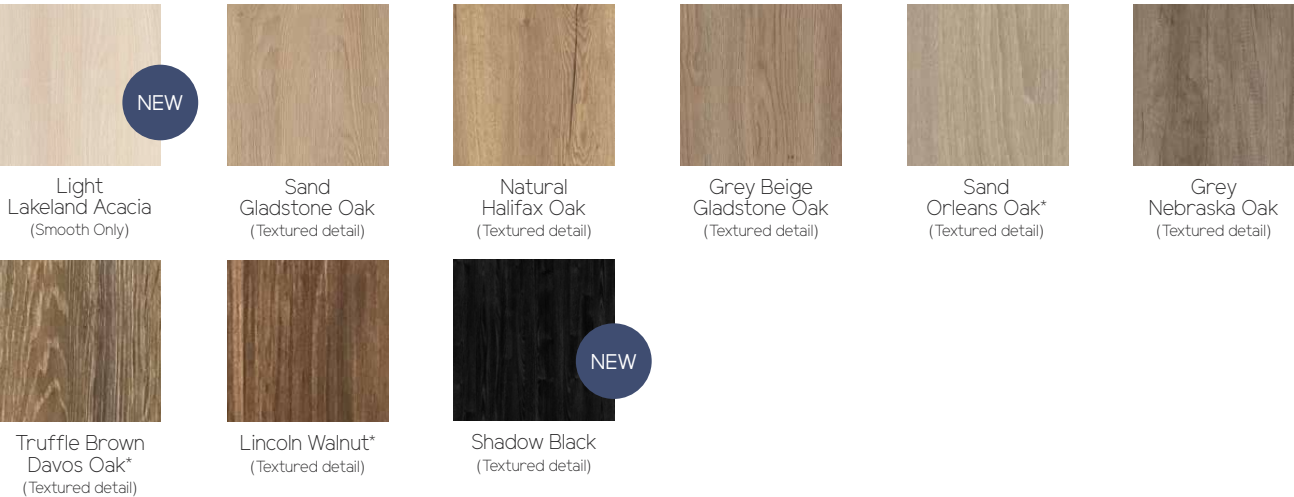

Material Effect - Available in smooth or textured laminated chipboard, with colour matched edging.



COMPLIMENTING CARCASE

Compliment your doors from our selection of standard carcase finishes. Colour matched carcasses available on demand - please speak to one of our designers.

Note: All finishes are representative. Due to print these will not exactly match the finished product. To see these finishes speak to your local showroom for physical samples.

Roma

Available in smooth painted 'routed' MDF

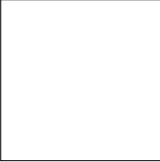

White
(Gloss & Super Matt)

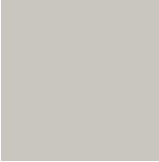

Light Grey
(Gloss & Super Matt)

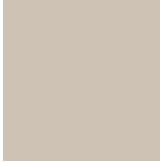

Cashmere
(Gloss & Super Matt)

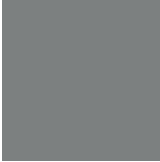

Dust Grey
(Gloss & Super Matt)



Anthracite
(Super Matt Only)

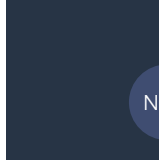

Indigo Blue
(Super Matt Only)

COMPLIMENTING CARCASE

Compliment your doors from our selection of standard carcass finishes. Colour matched carcasses available on demand - please speak to one of our designers.

Genoa

Available in smooth laminated MDF, with colour matched edging.

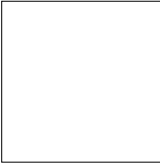

White
(Gloss & Super Matt)

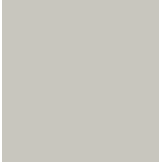

Dove Grey
(Gloss & Super Matt)

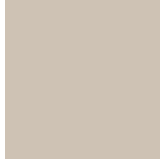

Cashmere
(Super Matt Only)

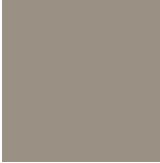

Stone Grey
(Gloss Only)



Dust Grey
(Super Matt Only)



Graphite
(Super Matt Only)



Kombu Green*
(Super Matt Only)



Indigo Blue
(Super Matt Only)

*Matching carcass not available

COMPLIMENTING CARCASE

Compliment your doors from our selection of standard carcass finishes. Colour matched carcasses available on demand - please speak to one of our designers.

Boston

Available in smooth wrapped 'routed' MDF, with colour matched melamine to the reverse.

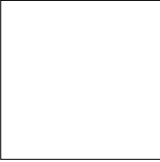

White
(Super Matt Only)

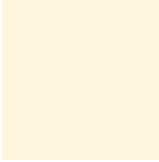

Ivory
(Matt Only)

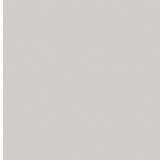

Dove Grey
(Super Matt Only)

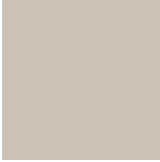

Cashmere
(Super Matt Only)



Dust Grey
(Super Matt Only)



Graphite
(Super Matt Only)



Kombu Green*
(Super Matt Only)



Indigo Blue
(Super Matt Only)

*Matching carcass not available

COMPLIMENTING CARCASE

Compliment your doors from our selection of standard carcass finishes. Colour matched carcasses available on demand - please speak to one of our designers.

Newark

Available in textured MDF, wrapped in PVC foil, with colour matched edging.



White
(Matt Textured Only)



White Grey*
(Matt Textured Only)



Ivory*
(Matt Textured Only)



Light Grey
(Matt Textured Only)



Cashmere
(Matt Textured Only)



Dust Grey
(Matt Textured Only)



Graphite
(Matt Textured Only)



Marine Blue*
(Matt Textured Only)



Taupe grey
(Matt Textured Only)

COMPLIMENTING CARCASE

Compliment your doors from our selection of standard carcass finishes. Smooth colour matched carcasses available on demand - please speak to one of our designers.

STANDARD CARCASE FINISHES

Chose from our selection of standard carcass finishes for any one of our door range.
Speak to one of our designers about colour matching your carcass to your doors.



Premium White
(Smooth Matt Only)



Alabaster White
(Smooth Matt Only)



Cashmere
(Smooth Matt Only)



Light Grey
(Smooth Matt Only)



Stone Grey
(Smooth Matt Only)



Dust Grey
(Smooth Matt Only)



Graphite
(Smooth Matt Only)



Indigo Blue
(Smooth Matt Only)



Natural Oak*
(Smooth Matt Only)



Walnut*
(Smooth Matt Only)

*Compliments the Natural Oak and Walnut from our Classic door range.

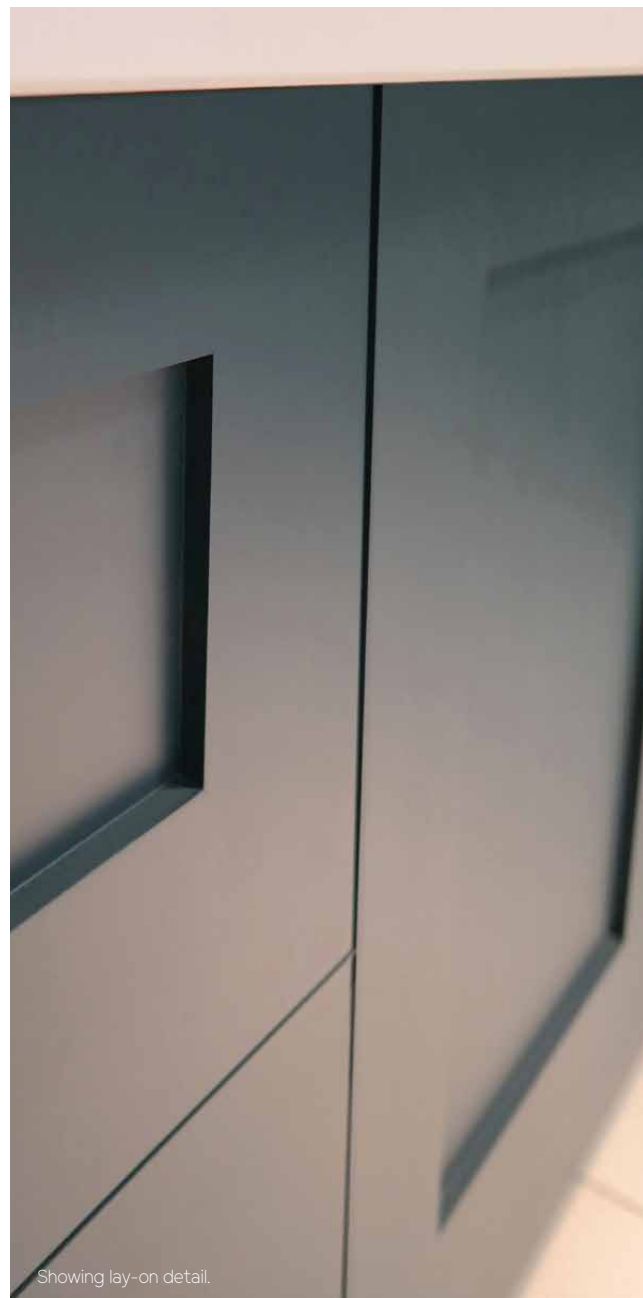

Showing lay-on detail.



Showing in-frame detail.

MODERN CLASSICS

All designs need to evolve, but there are times when a design is born and we keep hold of it. Our Classic ranges are designs of the past, with a slight modern twist.

Available in both a 'lay-on' or 'in-frame' designs. Look for the 'Lay-on / in-frame' door symbols on each intro page to see what door configurations you can achieve.

The 'lay-on' style is a door which sits to the front of the carcass with no visible frame surrounding it, creating a slightly more contemporary feel. The 'in-frame' style is the exact opposite, and uses the frame to encapsulate the door, creating a more classic look.

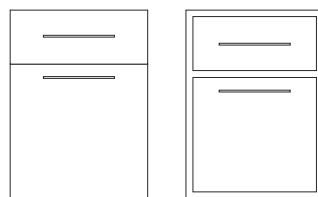

Lay-on design

In-frame design



Showing a grain texture finish.

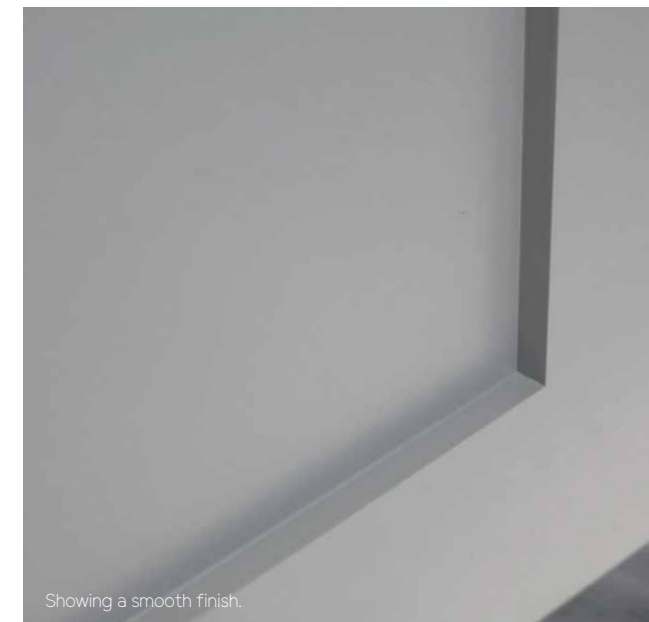

Showing a smooth finish.

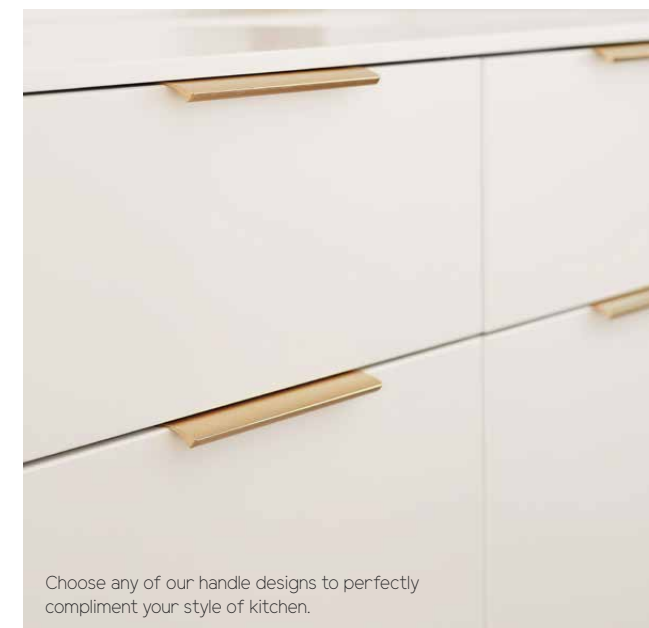

Choose any of our handle designs to perfectly compliment your style of kitchen.

LITTLE ADDED DETAILS

Our range of finishes will bring visual delight to your home. A kitchen is a personal space that's lived and breathed in, that's why it's important it resonates with you and your style. Each range has its own carefully picked palette, but if you still fancy creating something a bit different, our Classic doors have an added little perk.

All of our painted finishes in the Classic range (and our Stratford range from Contemporary) can be painted directly onto our Oak doors, leaving a grained texture as the end result. Alternatively, you can use the same colours as a smooth finish, leaving a perfectly seamless result.

Your kitchen, your home, your choice.

Now you've seen our selection of kitchens on offer, please come and visit our showroom to experience the true delight of our bespoke designs and service for yourself.



HANDCRAFTED KITCHENS

MADE IN BRITAIN
SINCE 1984



Andover Showroom

136-137, The Commercial Centre
Picket Piece, Andover
Hampshire, SP11 6RU

Tel: 01264 334111

andover@silverbrowkitchens.co.uk

SILVERBROWKITCHENS.CO.UK